

Self-Aligning Pads • with hard metal ball, ribbed and self-resetting  
22731.0392



Product Description

Especially designed for cast parts (hard casting crust). To be used as support, thrust pad and for build into clamping elements.  
By resetting to the parallel position the contact point of the self-aligning pad provides a defined initial position, thus preventing the pad clamping in an oblique position when inserting the workpiece.

Material

Spring element

- Thermoplastic PUR

Ball

- Hard metal, ribbed, nickel-plated

Body

- Stainless steel 1.4057, heat-treated

Drawing

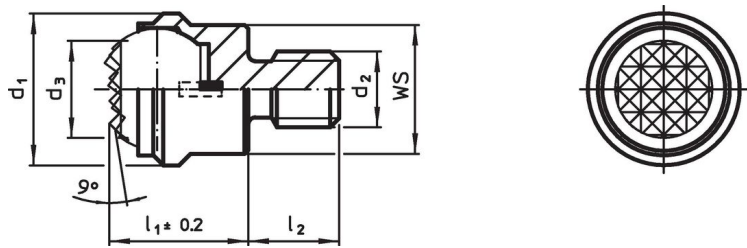

Order information

Dimensions						WS	Load capacity for static load max.	Tightening torque max.		Art. No.
d <sub>1</sub>	d <sub>2</sub>	d <sub>3</sub>	l <sub>1</sub> ±0.2	l <sub>2</sub> -0.5	Ball diameter					
[mm]										
						[mm]	[kN]	[Nm]	[g]	
with male thread, flat-faced ball, bearing surface ribbed, Stainless steel										
13	M8	8.3	13	8	10	11	10	25	15	22731.0392

### Application example

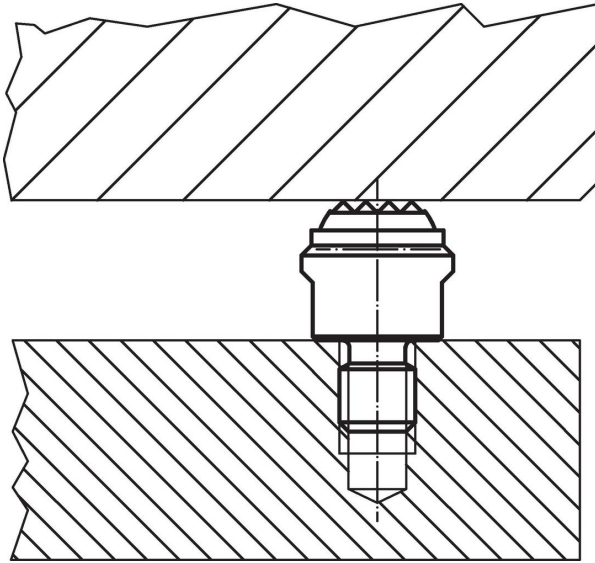

### Compliance

#### RoHS compliant

Compliant according to Directive 2011/65/EU and Directive 2015/863.

#### Does not contain SVHC substances

No SVHC substances with more than 0.1% w/w contained - SVHC list [REACH] as of 23.01.2024.

#### Does not contain Proposition 65 substances

No Proposition 65 substances included.

<https://www.P65Warnings.ca.gov/>

#### Free from Conflict Minerals

This product does not contain any substances designated as "conflict minerals" such as tantalum, tin, gold or tungsten from the Democratic Republic of Congo or adjacent countries.