

Workpiece Stops • swivelling EH 1705.



Product Description

- Can be mounted at the positions provided on both sides of the vice
- Fastening thread M 8
- Position of the 3rd axis of the workpiece can be preset and clamped
- Stop can be swung away from workpiece once clamped, to allow full access to workpiece face for tool access (repeatability of ± 0.01).

Material

- Steel, blackened

Drawing

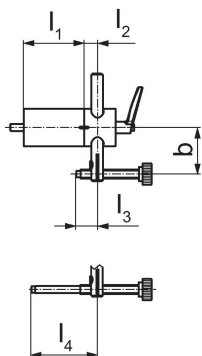

Order information

Dimensions								Art. No.
b min.	b max.	l ₁	l ₂	l ₃ min.	l ₃ max.	l ₄ min.	l ₄ max.	
[mm]								[g]
33	92	67	15	12	63.5	53.5	113.5	1705.100

Compliance

RoHS compliant

Compliant according to Directive 2011/65/EU and Directive 2015/863.

Does not contain SVHC substances

No SVHC substances with more than 0.1% w/w contained - SVHC list [REACH] as of 23.01.2024.

Does not contain Proposition 65 substances

No Proposition 65 substances included.

<https://www.P65Warnings.ca.gov/>

Free from Conflict Minerals

This product does not contain any substances designated as "conflict minerals" such as tantalum, tin, gold or tungsten from the Democratic Republic of Congo or adjacent countries.