

## Lateral Plungers • smooth, without seal - INCH

2B150.0030



## Product Description

To be used for positioning and applying pressure, e.g. during painting and sandblasting.

## Material

## Body

- Aluminium Al

## Spring

- Stainless steel

## Pin

- Steel, case-hardened, zinc-plated by galvanization

## Assembly

Installation by pressing in.

Formula for calculating the center distance for the mounting hole:

$$l_0 = z/2 + w + x,$$

$l_0$  = center distance,

$y$  = workpiece height,

$w$  = workpiece length,

$x$  = coordinate dimension,

$s$  = stroke,

$z$  = stop diameter

Calculation dimension  $x$ :

$y$  greater than or equal to  $l_2 - d_2/2$ ,

$$\text{then } x = d_2/2 - s$$

or

$y$  smaller than  $l_2 - d_2/2$ ,

$$\text{then } x = d_2/2 - s - [(l_2 - d_2/2 - y) \cdot 0,123]$$

## Characteristic

Version light spring load = spring from stainless steel

## More information

## Further products

- Eccentric Mounting Bushings, for lateral plungers, smooth - INCH

## Drawing

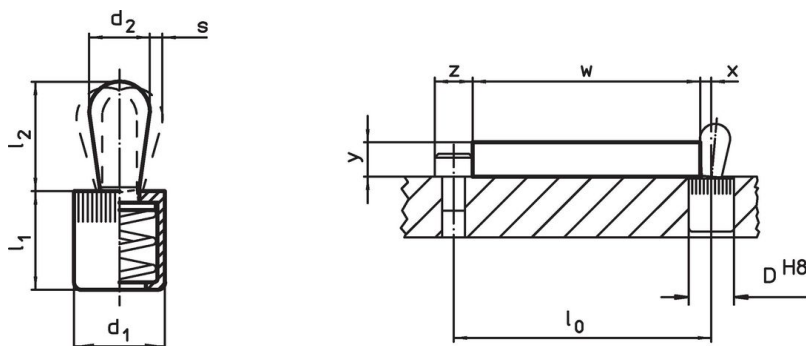



## Order information

Dimensions		Spring load F max. <sup>1)</sup> ~ [lb]	Dimensions		Stroke s [in]	Location hole D H8 [in]	max. [°F]	oz	Art. No.
d <sub>1</sub>	d <sub>2</sub>		l <sub>1</sub> -0.08	l <sub>2</sub>					
[in]	[in]		[in]	[in]					
Pin: Steel/Light spring load									
1/2	0.315	11.2	0.525	0.535	0.09	1/2	482	0.261	2B150.0030

<sup>1)</sup> statistical average value

Accessories

	Dimensions d <sub>1</sub> [in]	 [oz]	Art. No.
assembly tool			
	1/2	2.321	22150.0832

Application example



Compliance

RoHS compliant

Contains lead - compliant according to exceptions 6a / 6b / 6c.

Contains SVHC substances >0,1% w/w

Contains lead - SVHC list [REACH] as of 23.01.2024.

Contains Proposition 65 substances



Lead can cause cancer and reproductive harm from exposure  
<https://www.P65Warnings.ca.gov/>

Free from Conflict Minerals

This product does not contain any substances designated as "conflict minerals" such as tantalum, tin, gold or tungsten from the Democratic Republic of Congo or adjacent countries.