

Connecting Elements • modular, pneumatically operated, reinforced, protected against twisting  
1990.403



Product Description

Material

- Body**
- Steel, case-hardened, ground
- Control module**
- Aluminium Al

More information

- Further products**
- Connecting Rings
  - Coverings, for connecting elements

Drawing

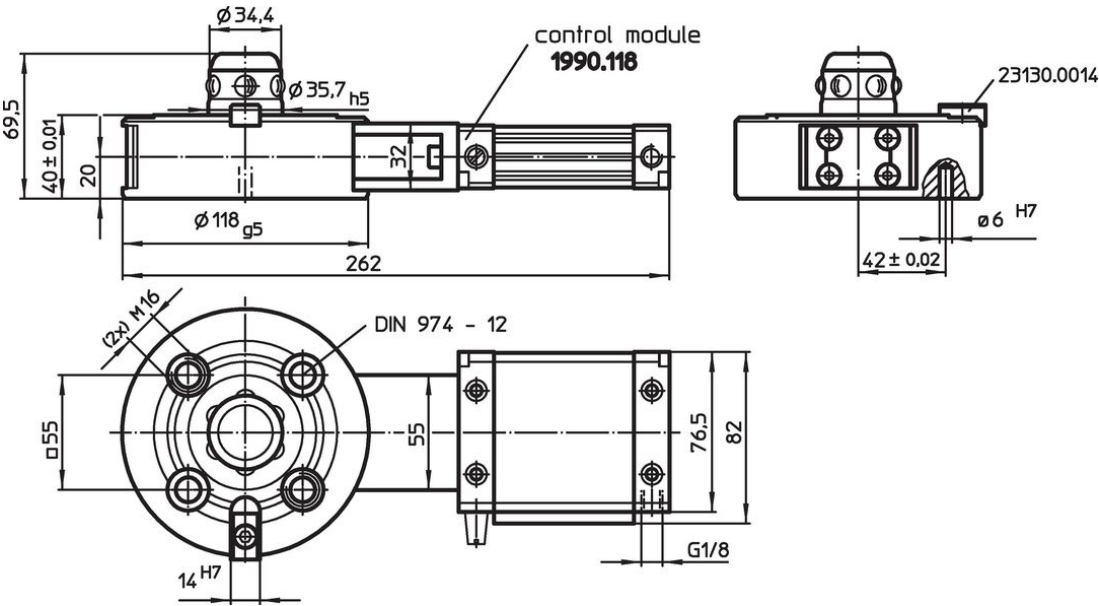

Order information

| Holding force | Centering accuracy<br>< | Release pressure |  | Art. No. |
|---------------|-------------------------|------------------|---|----------|
| [N]           | [mm]                    | [bar]            | [kg]  |          |
| 10000         | 0.01                    | 6                | 4   | 1990.403 |

## Application example

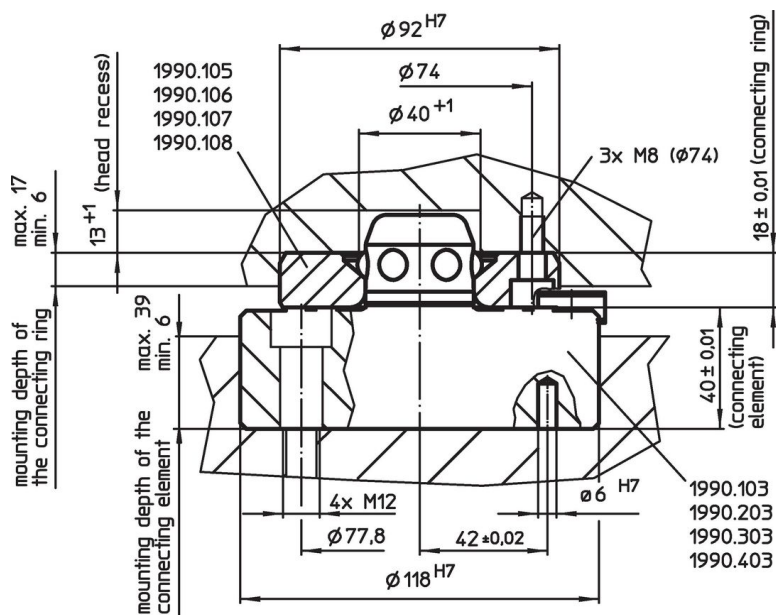

## Compliance

**Non-RoHS compliant**

Not compliant according to Directive 2011/65/EU and Directive 2015/863.

**Contains SVHC substances >0,1% w/w**

Contains lead - SVHC list [REACH] as of 23.01.2024.

**Contains Proposition 65 substances**



Lead can cause cancer and reproductive harm from exposure

<https://www.P65Warnings.ca.gov/>

### Free from Conflict Minerals

This product does not contain any substances designated as "conflict minerals" such as tantalum, tin, gold or tungsten from the Democratic Republic of Congo or adjacent countries.