

Set Collars  
25069.0010



Product Description

Set collars with universal applicability, e.g. as a fixed stop.  
Set collars with strong clamping force.

Material

Screw

- Steel

Set collar

- Steel, black, steam oxidized

Drawing

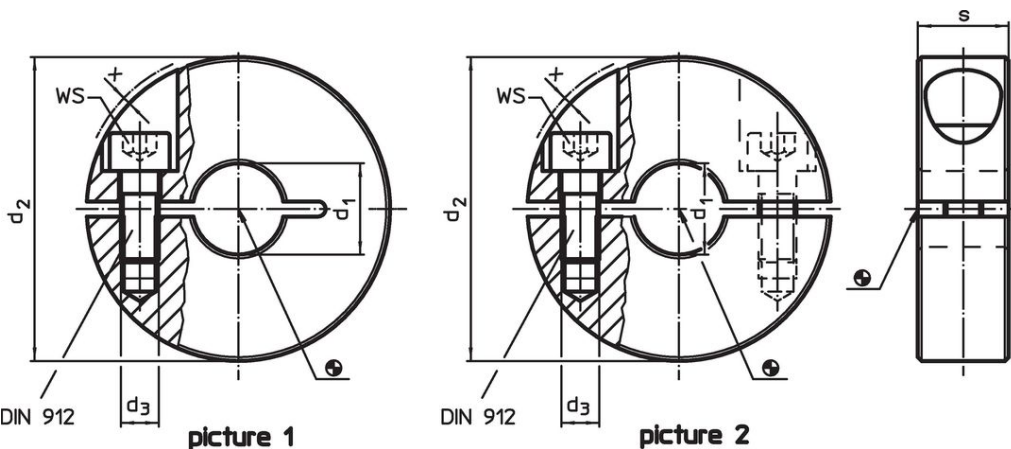

Order information

Dimensions					WS		Art. No.
d <sub>1</sub> H10	d <sub>2</sub>	d <sub>3</sub> [mm]	s	x	[mm]	[g]	
slotted – picture 1, Steel							
10	26	M4	11	1.6	3	32	25069.0010

### Application example

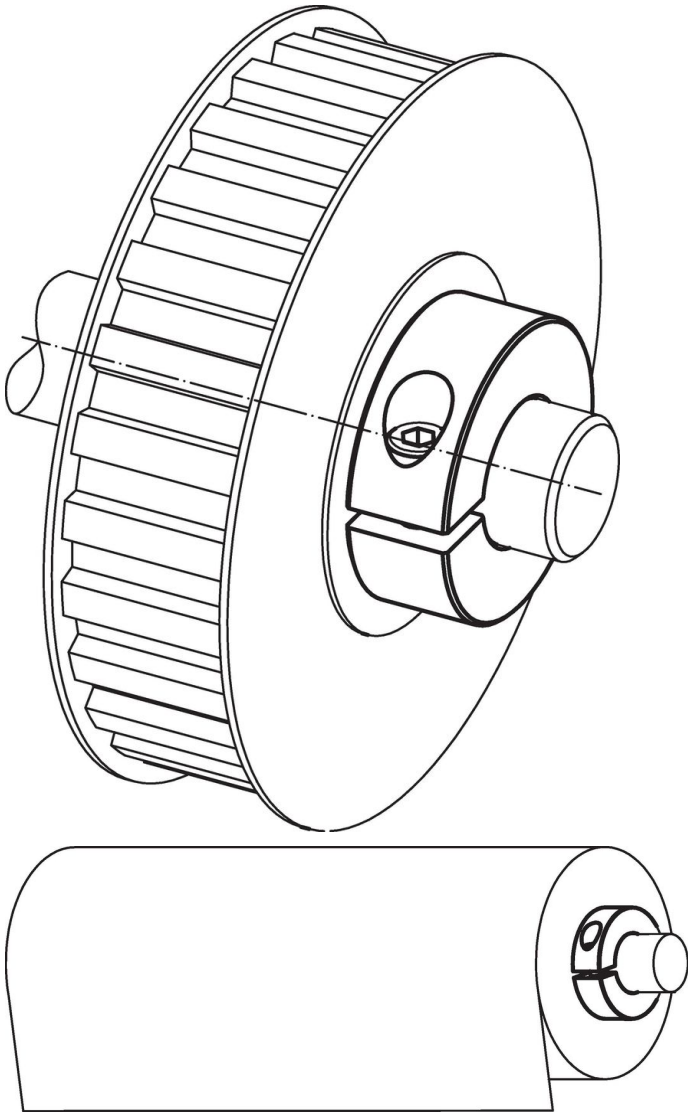

### Compliance

#### RoHS compliant

Compliant according to Directive 2011/65/EU and Directive 2015/863.

#### Does not contain SVHC substances

No SVHC substances with more than 0.1% w/w contained - SVHC list [REACH] as of 23.01.2024.

#### Does not contain Proposition 65 substances

No Proposition 65 substances included.

<https://www.P65Warnings.ca.gov/>

#### Free from Conflict Minerals

This product does not contain any substances designated as "conflict minerals" such as tantalum, tin, gold or tungsten from the Democratic Republic of Congo or adjacent countries.