

Self-Aligning Pads • with hard metal ball, ribbed  
22730.0381



Product Description

Especially designed for cast parts (hard casting crust). To be used as support, thrust pad and for build into clamping elements.

Material

- Ball**
- Hard metal, ribbed, nickel-plated
- Body**
- Heat-treated steel, tempered, phosphated

More information

**Notes**

Ball protected against rotating.  
Loading capacity valid for steel and stainless steel designs.

Drawing

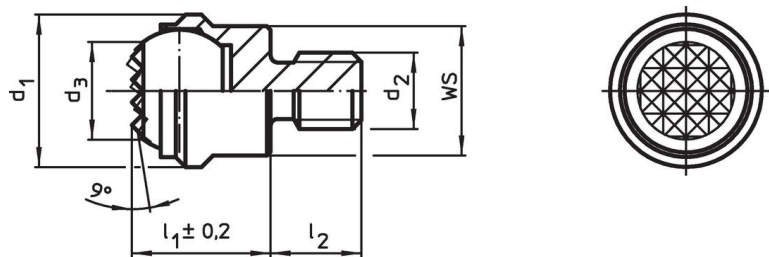

Order information

Dimensions						WS	Load capacity for static load max.	Tightening torque max.		Art. No.
d <sub>1</sub>	d <sub>2</sub>	d <sub>3</sub>	l <sub>1</sub> ±0.2 [mm]	l <sub>2</sub> -0.5 [mm]	Ball diameter					
with male thread, flat-faced ball, bearing surface ribbed, Heat-treated steel										
30	M16	20	27	16	25	27	90	206	186	22730.0381

## Application example

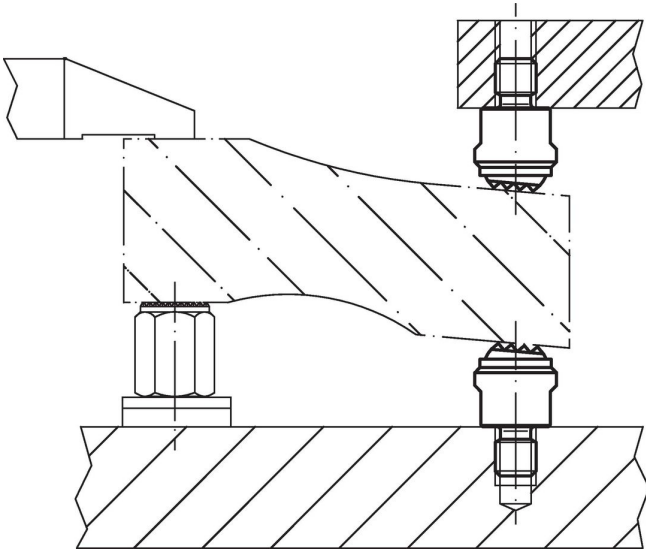

## Compliance

### RoHS compliant

Compliant according to Directive 2011/65/EU and Directive 2015/863.

### Does not contain SVHC substances

No SVHC substances with more than 0.1% w/w contained - SVHC list [REACH] as of 23.01.2024.

### Does not contain Proposition 65 substances

No Proposition 65 substances included.

<https://www.P65Warnings.ca.gov/>

### Free from Conflict Minerals

This product does not contain any substances designated as "conflict minerals" such as tantalum, tin, gold or tungsten from the Democratic Republic of Congo or adjacent countries.