

U-Handles • with support washer  
24310.0330



Product Description

U-handles are used, for example, on machine doors, furniture doors, cabinet doors, drawers and drawer units.  
These rounded U-handles are characterised by their ergonomic and stable construction and their simple and timeless design.

Material

- Handle**
- Steel, plastic coated, black
- Support washer**
- Zinc die-cast, nickel-plated

Assembly

The supporting washer provides a good bearing surface. Suitable washers are joined in loose form.

Drawing

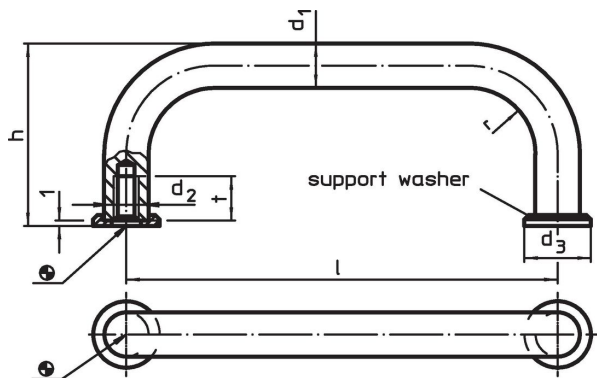

Order information

Dimensions								Art. No.
d <sub>1</sub>	l ±0.5	d <sub>2</sub>	d <sub>3</sub>	h	r	t min.		
[mm]								
Steel								
8	88	M4	12	35	10	8	54	24310.0330

Compliance

**RoHS compliant**  
Contains lead - compliant according to exceptions 6a / 6b / 6c.

**Contains SVHC substances >0,1% w/w**  
Contains lead - SVHC list [REACH] as of 23.01.2024.

**Contains Proposition 65 substances**

  
Lead can cause cancer and reproductive harm from exposure  
<https://www.P65Warnings.ca.gov/>

**Free from Conflict Minerals**  
This product does not contain any substances designated as "conflict minerals" such as tantalum, tin, gold or tungsten from the Democratic Republic of Congo or adjacent countries.